



Medline® Transport Wheelchairs



MDS808150 MDS808200



MDS808210AR MDS808210AB
MDS808210TC



MDS808200AR MDS808200AB



MDS808200SLRR MDS808200SLBR
MDS808200SLRC MDS808200SLBC

Owner's & Maintenance Guide

DEALER: This manual must be given to the user of the wheelchair.

USER: Please read this manual before operation for warnings, maintenance and safe usage instructions of this wheelchair.

***Congratulations on your selection of a
Medline Transport Wheelchair.***

Medline wheelchairs are the result of extensive engineering and are manufactured to meet our rigid specifications and to surpass your expectations.

Medline wheelchairs are designed to combine comfort, safety and reliability. Medline Industries, Inc. is committed to the quality of our products and to the satisfaction of our customers.

NOTE: Transport wheelchairs are ideal for airports, shopping centers or other public places that require short term transport from one location to another. They are designed for safe and efficient transport with someone pushing the chair. Transport wheelchairs are not intended for independent use by individuals as the design does not allow maneuvering by the occupant.

REORDER NUMBERS:

MDS808150 Transport	Excel	17" wide, permanent full-length arms, swing-away detachable footrests, steel frame, black upholstery
MDS808200 Transport	Excel	19" wide, permanent full-length arms, swing-away detachable footrests, steel frame, black upholstery
MDS808210AR Deluxe Aluminum Transport	Excel	19" wide, permanent full-length arms, swing-away detachable footrests, red aluminum frame, black upholstery, hand grip wheel locks
MDS808210AB Deluxe Aluminum Transport	Excel	19" wide, permanent full-length arms, swing-away detachable footrests, blue aluminum frame, black upholstery, hand grip wheel locks
MDS808200AR Aluminum Transport	Excel	19" wide, permanent full-length arms, swing-away detachable footrests, red aluminum frame, black upholstery
MDS808200AB Aluminum Transport	Excel	19" wide, permanent full-length arms, swing-away detachable footrests, blue aluminum frame, black upholstery
MDS808210TC Aluminum Transport	Excel	19" wide, permanent full-length arms, swing-away detachable footrests, blue aluminum frame, black upholstery, hand grip wheel locks, two tone
MDS808200SLRR/SLRC MDS808200SLBR/SLBC Freedom Superlight Transport Wheelchair		19" wide, permanent desk-length arms*, swing-away detachable footrests, red aluminum frame, black upholstery *desk length arms allow for greater ease in getting into/out of the chair

Typical Product Specifications for Transport Wheelchairs:

MODEL	Excel Transport	Excel Transport	Excel Aluminum Transport	Excel Deluxe Aluminum Transport	Excel Superlight Freedom Transport
Model #	MDS808150	MDS808200	MDS808200AR/AB	MDS808210AR/AB/TC	MDS808200SLRR/SLRC MDS808200SLBR/SLBC
Size (seat width)	17"	19"	19.5"	19"	19"
Seat depth	16"	16"	16"	16"	16"
Weight (w/o legrests)	25 lbs	25 lbs	15.5 lbs	23.5lbs	15.5 lbs
Weight Capacity	300lbs	300lbs	300lbs	300lbs	300lbs
Armrests	permanent full-length	permanent full-length	permanent full-length	permanent full-length	fixed desk length
Arm pads	vinyl, black	vinyl, black PC - nylon, plaid	nylon, black	nylon, black PC – nylon, plaid	nylon, black
Legrests	steel, chrome plated	steel, chrome plated	aluminum, red	aluminum red/blue/red	aluminum, red
Frame	fixed /folding backrest	fixed /folding backrest	fixed /folding backrest	fixed /folding backrest	fixed /folding backrest
Upholstery	nylon, black, seat belt	nylon, black or plaid, seat belt	nylon, black, seat belt, hand loop	nylon, black or plaid, seat belt	nylon, black, seat belt, hand loop
Casters	plastic, black	plastic, black	plastic, black	plastic, black	plastic, black
Front tire	8" polyurethane, black	8" polyurethane, black	5.5" polyurethane black	8" polyurethane, black	5.5" polyurethane, black
Rear tire	8" polyurethane, black	8" polyurethane, black	8" polyurethane, black	12" polyurethane, black	8" polyurethane, black
Fork	steel, chrome plated	steel, chrome plated	aluminum, silver	aluminum, silver	plastic, black
Foot plate	aluminum	Aluminum	plastic, black	plastic, black	plastic, black
Brake style	push to lock brake	push to lock brake	pull to lock brake	push to lock brake	pull to lock brake
Brakes	rear wheels	rear wheels	rear wheels	hand grip and rear wheels	rear wheels
Warranty : Frame & Crossbar	Limited Lifetime	Limited Lifetime	Limited Lifetime	Limited Lifetime	Limited Lifetime
Warranty: Upholstery Parts & Components	1 year	1 year	1 year	1 year	1 year
HCPCS code	--	--	E1038	E1038	--
Miscellaneous					cup holder, wallet with key ring, cell phone bag on back upholstery

 **WARNINGS**

A CAREGIVER / TRANSPORTER MUST BE PRESENT AT ALL TIMES WHILE THE TRANSPORT WHEELCHAIR IS IN USE. NEVER LEAVE THE OCCUPANT UNATTENDED. THIS WHEELCHAIR DESIGN IS NOT INTENDED TO ALLOW A PATIENT TO MANEUVER THE WHEELCHAIR.

TO ENSURE YOUR SAFETY IN USING THIS MEDLINE TRANSPORT CHAIR, ALL WARNINGS AND SAFETY INFORMATION AND ALL INSTRUCTIONS MUST BE FOLLOWED. FAILURE TO DO SO MAY RESULT IN SERIOUS BODILY INJURY OR DAMAGE TO THE CHAIR.

DO NOT USE THIS PRODUCT WITHOUT FIRST READING AND UNDERSTANDING THE INSTRUCTIONS CONTAINED IN THIS BOOKLET. IF YOU ARE UNABLE TO UNDERSTAND THE WARNINGS, CAUTIONS OR INSTRUCTIONS, CONTACT A HEALTHCARE PROFESSIONAL, DURABLE MEDICAL DEALER OR TECHNICAL PERSONNEL, OR CONTACT MEDLINE AT 1-800-MEDLINE BEFORE USE - OTHERWISE SERIOUS BODILY INJURY OR PRODUCT DAMAGE MAY OCCUR.

A QUALIFIED WHEELCHAIR TECHNICIAN MUST PERFORM ANY REPAIR OR CHANGE TO THIS WHEELCHAIR OR SERIOUS INJURY MAY OCCUR. TECHNICIANS: DO NOT SERVICE THE WHEELCHAIR WITHOUT FIRST READING AND UNDERSTANDING THIS OWNER'S MANUAL. IF YOU ARE UNABLE TO UNDERSTAND THE WARNINGS, CAUTIONS, OR INSTRUCTIONS, CONTACT MEDLINE AT 1-800-MEDLINE.

DO NOT USE ACCESSORIES, PARTS, OR ADAPTERS OTHER THAN THOSE AUTHORIZED BY MEDLINE.

CONSULT WITH YOUR DOCTOR, PHYSICAL OR OCCUPATIONAL THERAPIST, OR OTHER QUALIFIED PROFESSIONAL REGARDING THE SELECTION OF THE TYPE OF WHEELCHAIR AND ACCESSORIES BEST SUITED TO YOUR INDIVIDUAL NEEDS AND CAPABILITIES.

TABLE OF CONTENTS

Reorder Numbers	2
Product Specifications	3
General WARNINGS	4
Table of Contents	5
WARNINGS and Safety Instructions	6
Guidelines: Safety and Handling of Wheelchairs	9
List of Contents	12
General Use Instructions	
Opening/Closing the Wheelchair.....	12
Folding/Unfolding seat back.....	13
Wheel Locks.....	14
Adjusting the Wheel Locks.....	15
Locking/Unlocking handgrip (specific models).....	18
Installing / Removing the Swing-Away Legrest Riggings.....	19
Safety Inspection and Maintenance	20
Monthly Check list / Troubleshooting.....	20
Installing/Removing front wheels.....	21
Medline Limited Warranty.....	22
Safety Inspection Checklist.....	23

WARNINGS & SAFETY INSTRUCTIONS



General Information

DO NOT use this product without first reading and understanding the instructions contained in this booklet. If you are unable to understand the Warnings, Cautions or Instructions, contact a healthcare professional, durable medical equipment dealer or technical personnel, or contact Medline at 1-800-Medline before use - otherwise serious bodily injury or product damage may occur.

Transport wheelchairs are ideal for airports, shopping centers or other public places that require short term transport from one location to another. They are designed for safe and efficient transport with someone pushing the chair. Transport wheelchairs are not intended for independent use by wheelchair-bound individuals. The design does not allow maneuvering by the occupant.

DO NOT use the wheelchair in a vehicle for transport. This wheelchair has not been approved as a seat surface to be used within a vehicle of any kind. Always transfer the wheelchair user to an approved vehicle seat and use restraints available from the auto industry for this application.

DO NOT exceed the weight capacity of the wheelchair: 300lbs. The weight capacity includes the weight of the rider plus items carried or attached to the wheelchair.

DO NOT use the wheelchair while weight training. Medline wheelchairs have not been tested for any type of weight training. If the chair is used during weight training, Medline will not be held liable. If the weight capacity is exceeded, risk of fall, tip-over or loss of control may occur which can result in bodily injury or product damage.

Use of the seat belt is recommended to maximize safety and stability.



Environmental

The wheelchair is designed for use on firm, even surfaces such as concrete, asphalt, and indoor floors and carpeting.

DO NOT operate the wheelchair on streets or roadways.

DO NOT operate the wheelchair on loose, slippery, or uneven surfaces such as sand, gravel, hills, dirt roads, or ice.

DO NOT operate the wheelchair on inclines greater than 10% (6 degrees) without assistance.

DO NOT attempt to go up or down inclines that are covered with oil, water, ice or any other potentially slippery substance.

DO NOT attempt to ride over curbs or obstacles. Doing so may cause your wheelchair to tip over and cause bodily harm to you or damage to the wheelchair.

DO NOT use the wheelchair on stairs or escalators.

WARNINGS & SAFETY INSTRUCTIONS



General Use

DO NOT stand on the frame of the wheelchair.

DO NOT stand or put pressure on the footrests. When getting in or out of the wheelchair, make sure the footplates are in the up position.

DO NOT attempt to lift the wheelchair by any detachable components.

There are potential finger pinch point areas at moving parts and between the seat frame and the seat cradles on some models. When opening the wheelchair, take care not to place your hand or fingers between the seat frame and the seat cradles (if present) or on any other moving parts.

ALWAYS keep hands and fingers away from moving parts. **DO NOT** sit in the wheelchair until the seat is completely in the open position. Risk of injury may occur if care is not taken.

Ensure the seatback fold-down section is locked in the upright position before use.

The wheelchair should be on a stable, level surface with the wheel locks engaged before transferring the user to or from the wheelchair.

Completely engage the wheel locks when entering and leaving the wheelchair or using the wheelchair in an elevator or a wheelchair lift.

DO NOT transfer in or out of the wheelchair on your own unless you have sufficient upper body strength, balance and agility and have been instructed in transfer techniques by a health professional. Every precaution should be taken to reduce the gap distance between the wheelchair and the target seat or bed. Turn both casters parallel to the object you are transferring to.

DO NOT use the wheel locks (or hand grip locks if present) to stop the wheelchair from moving. Wheel locks are not brakes. **DO NOT** use the wheel locks to slow your descent down an incline.

Changing direction when going down an incline could cause instability.

DO NOT lean forward out of the wheelchair any farther than the length of the armrests.

DO NOT attempt to reach for objects if doing so means you must move forward in the seat.

DO NOT attempt to reach objects if you have to pick them up from the floor by reaching down between your knees.

DO NOT shift your weight or sitting position toward the direction you are reaching as the wheelchair may tip over.

DO NOT attempt to lean over the top of the back upholstery to reach objects.

Before leaning or reaching forward, make sure to rotate the casters straight ahead toward the front of the wheelchair and engage the wheel locks to prevent the wheelchair from tipping over or moving.

WARNINGS & SAFETY INSTRUCTIONS



General Use

DO NOT tip the wheelchair without assistance. **DO NOT** lean the wheelchair back since this can cause the wheelchair to tip over. If trying to reach objects, reach back only as far as your arm will extend without altering your seating position.

Any person assisting the rider in maneuvering or lifting of the wheelchair must have sufficient strength and be able to see obstacles in the path of travel. When learning a new assistance technique, have an experienced assistant help you before attempting it alone. Remember to use good body mechanics.

Contact with water or excess moisture may cause the non-aluminum wheelchairs to rust or corrode. **DO NOT** use the chair in a shower, pool or other body of water. Avoid excess moisture (example: do not leave the chair in a damp bathroom while taking a shower). Dry the chair immediately if exposed to moisture.

When cleaning the hand grips, use only a clean towel lightly dampened with cool water. Ensure the hand grips are dry before use. Use of soap or ammonia-based cleaning solutions may result in the hand grips sliding off.

If the wheelchair is exposed to extreme temperatures, high humidity and/or becomes wet, check the hand grips to ensure they are not loose and do not twist on the handle.

Avoid storing or using the wheelchair near open flames or combustible products.



Adjustments

DO NOT operate, maintain, or adjust the wheelchair without reading and understanding all instructions in the manual.

DO NOT adjust the footrests any closer than 2 ½ inches from the floor.

DO NOT modify the wheelchair. Examples: drilling holes, grinding, welding parts, using non-authorized / non-approved parts. Such modifications may change the chair's structure and center of balance, which may increase the risk of serious injury to the user and void the warranty.



Before EACH Use

- ✓ Make sure the chair rolls easily and that all parts work smoothly.
- ✓ Check for noise, vibration, or any change in use. Changes may indicate loose parts or wheelchair damage.
- ✓ Check to ensure wheel locks are in good working order.
- ✓ Make sure hand grips are not loose and cannot be moved or twisted.
- ✓ Make sure the seatback is locked in the upright position.
- ✓ Have any problem found repaired promptly with authorized parts.

GUIDELINES: SAFETY & HANDLING OF WHEELCHAIRS

Center of Gravity, Balance and Stability

The transport wheelchair has been designed to be safe and stable during normal transport activity as long as proper balance is maintained. The point at which a wheelchair will tip forward, backward, or to the side depends on its center of balance. To assure stability and proper operation of the wheelchair, the center of gravity must be maintained in the chair. Center of gravity is the point at which all the weight of an object can be considered to be concentrated and represents the balance point.

Most activities such as transferring in and out of the wheelchair, bending, and reaching affect the center of gravity and weight distribution of the wheelchair. Addition of accessories such as a backpack will also re-distribute weight. Loss of proper balance may cause the chair to tip over. Use of the seat belt is advised to help maintain stability by minimizing movement within the wheelchair seat. The use of anti-tip devices (available only for MDS808200SLR /C models), especially when maneuvering on ramps or inclines, will also enhance safety.

Transport wheelchairs are designed for safe and efficient transport with someone pushing the chair. Transport wheelchairs are not intended for independent use by wheelchair-bound individuals. The design does not allow maneuvering by the occupant.

To determine safety limits of the transport chair, practice with activities such as transferring, bending, and reaching with a healthcare professional that is knowledgeable about wheelchair use.

To assure safe operation of the transport wheelchair, ALL of the Warnings and Instructions in this manual must be followed. Failure to do so may result in tipping the wheelchair over or causing the user to fall which may result in serious bodily injury or damage to the wheelchair.

Some **basic** wheelchair safety guidelines follow. The guidelines are critical for standard wheelchair use, however, the principles also hold true for transport chairs. If any of the following activities are required while using the transport chairs, these guidelines **must** be followed to ensure safety and to avoid potential injury to the user or the transporter and to avoid damage to the chair.

Reaching / Leaning / Bending – FORWARD or SIDEWAYS

- Position the wheelchair as close as possible to the object.
- Make sure the front casters are pointing in a forward position. This extends the wheel base and will help stabilize the chair.
- Make sure the wheel locks are engaged before activity.
- DO NOT attempt to reach for objects if doing so means you must move forward in the seat. DO NOT shift your weight toward the direction you are reaching.
- DO NOT attempt to reach objects if you have to pick them up from the floor by reaching down between your knees.
- DO NOT shift your weight or seat position toward the direction you are reaching.

GUIDELINES: SAFETY & HANDLING OF WHEELCHAIRS

Reaching / Leaning – BACKWARD

- Position the wheelchair as close as possible to the object.
- Make sure the front casters are pointing in a forward position. This extends the wheel base and will help stabilize the chair.
- DO NOT engage the wheel locks – if your weight shifts while reaching backwards it is better for the wheelchair to roll than to tip.
- DO NOT lean back over the top of the back upholstery.
- Reach back only as far as your arm will extend without changing your position in the seat.

Transferring into and out of the wheelchair

Transport chairs do not have detachable arms, requiring the user to be able to stand and assist with pivoting to the chair.

- Position the wheelchair as close as possible.
- Make sure both wheel locks are engaged.
- Remove or swing away the footrests that are in the transfer path.
- DO NOT put weight on the foot rests.
- Transfer as far back into the seat or onto the bed/chair as possible.

Obstacles

Obstacles such as floor threshold strips, uneven floors, cords or items on the floor, or cracks in pavements can damage your wheelchair and may cause loss of control or a tip over. Be alert! Scan your path and avoid any items that may cause instability.

Curbs, Steps and Stairs

Do not attempt to negotiate curbs or single steps without assistance. Ask your healthcare worker to provide instructions regarding safe wheelchair use for curbs, steps and stairs. Proper body mechanics and awareness of the center of gravity is crucial for these maneuvers. The step tubes at the back of the chair are utilized to tilt the transport chair backwards until the balance point is achieved and the front casters clear the curb/step. Gently lower the front wheels to the ground and slowly roll the transport chair forward until the rear wheels roll up over the curb/step.

Extreme caution is required if it is absolutely necessary to maneuver an occupied chair up or down stairs. Two assistants with adequate body strength and endurance must be present. DO NOT lift the chair by any removable parts (i.e. swing-away footrests). Make sure the hand grips are not loose. Techniques for going up or down steps should be received from a health care professional familiar with wheelchair use and practiced before attempting to transport on stairs. If at all possible, an alternate means of transport up or down stairs is recommended.

GUIDELINES: SAFETY & HANDLING OF WHEELCHAIRS

Ramps / Inclines

The assistant must know their capabilities and limitations in terms of strength and endurance before attempting to go up or down a ramp. Slopes will change the center of gravity. DO NOT attempt to negotiate steep inclines greater than 10% (6 degrees, or one foot of rise or fall for every ten feet of ramp length) without an experienced assistant. Use of anti-tip devices are encouraged (available only for MDS808200SLR /C models), however, they may not prevent a tip-over. Sometimes anti-tip devices may catch at the beginning of a ramp. If this occurs, they will need to be disengaged and extra care should be taken. Backpacks or other gear on the back of the wheelchair will cause it to tip backward more easily. Training and practice negotiating ramps with a healthcare professional is recommended.

- Go as straight up or down the incline as possible.
- Check the ramp for any obstacles, bumps, depressions, or wetness before beginning. Ask for additional assistance if necessary.
- Stay in the center of the ramp if possible.
- Avoid changing direction while on the ramp as this may cause loss of control of the wheelchair.
- Avoid stopping on a ramp. Stopping may cause loss of control of the wheelchair. If stopping is necessary, avoid sudden, abrupt forward movement when you resume propelling the chair as that could cause instability.
- When going up an incline, the occupant should lean forward. This will adjust the center of gravity to counteract the tendency of the wheelchair to tip backward.
- When going down a ramp, the occupant should face forward and lean backward into the seat. Descent should always be done slowly. **DO NOT** use wheel locks as brakes to slow down or stop the chair. Attempting to use the wheel locks could result in accidental locking, veering or tipping to one side, or suddenly stopping.
- When going down a steep incline, the assistant should turn the chair and go down backwards to avoid tipping the occupant out of the chair.

Basic Information for Wheelchair Assistants / Transporters

Work with the wheelchair user's healthcare professional or your institution to learn safe ways to assist that are within your capability and comfort level. To prevent injury to yourself or the chair occupant use good body mechanics:

- Always tell the rider what you intend to do so he/she is ready for your actions and can assist with maintaining a balanced center of gravity for stability.
- Bend at the knees, not at the waist. Keep knees bent, not locked straight.
- Use legs for strength, not the weaker muscles of the back or arms. This will help prevent back strain.
- Do not twist at the waist. Keep the torso facing the same direction as the hips and move the feet to turn. This will help prevent back strain.
- Maintain a straight back. Hunching or rounding the shoulders can cause back strain.
- Do not hesitate to call for additional assistance if needed.
- If you do not feel comfortable with an activity you are requested to assist with (such as negotiating a step or a steep incline), you may decline to assist and should help find appropriate assistance for the occupant.

List of Contents

1. Transport Wheelchair
2. Foot rests
3. Manual & Tool Kit



GENERAL USE INSTRUCTIONS

OPENING AND FOLDING THE WHEELCHAIR

IMPORTANT NOTES:

There are potential finger pinch point areas at moving parts and between the seat frame and the seat cradles on some models. When opening the wheelchair, take care not to place your hand or fingers between the seat frame and the seat cradles (if present) or on any other moving parts.

ALWAYS keep hands and fingers away from moving parts. **DO NOT** sit in the wheelchair until the seat is completely in the open position. Risk of injury may occur if care is not taken.

To OPEN the Chair

1. Hold onto one armrest and push the opposite side to open the chair.
2. With your fingers and thumbs pointed towards the inside of the wheelchair, push downward on the seat to ensure the wheelchair is fully open. Keep hands and fingers away from any moving parts.

Alternative method to open the chair:

1. Tilt the chair to one side by grasping the hand grip or armrest nearest to you.
2. With fingers pointed away from the seat rail, push down on one side of the seat frame / rail until the wheelchair is fully open. Keep hands and fingers away from any moving parts.

To CLOSE / FOLD the chair

1. Ensure the swing-away legrests are in the forward and locked position.
2. Fold the footplates up to the vertical position.
3. Using both hands, grasp the center of the seat upholstery at the front and back edge and lift the seat up.

GENERAL USE INSTRUCTIONS

Alternative method to close the chair:

1. Ensure the swing-away legrests are in the forward and locked position.
2. Fold the footplates up to the vertical position.
3. Grasp the handles/straps on each side of the seat.
4. Pull up until the chair is fully closed.
5. The handles can be used to carry the closed wheelchair.

Folding / unfolding the seat back

The top portion of the wheelchair seat back can be folded down for more compact storage.

Caution: DO NOT use the wheelchair with the seat back in the folded down position.

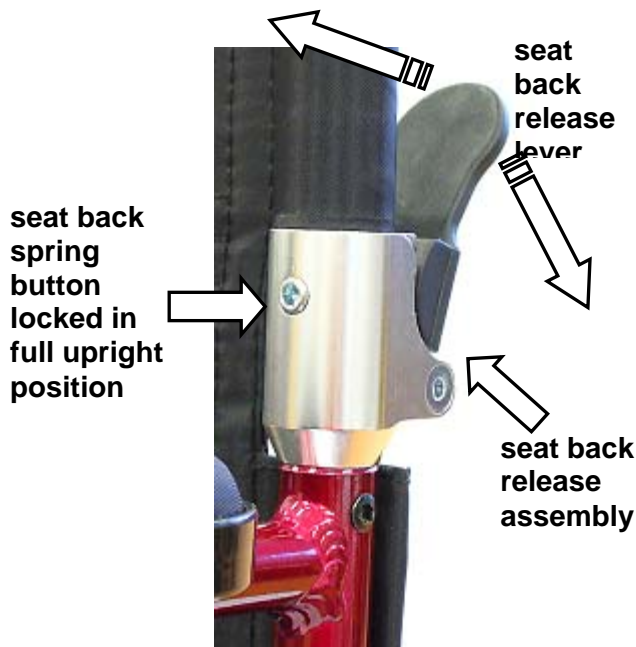

To fold the back down:

1. Push/pull down on the seat back release lever on each side of the chair back canes.
2. Fold the top portion of the seat back frame / upholstery down.

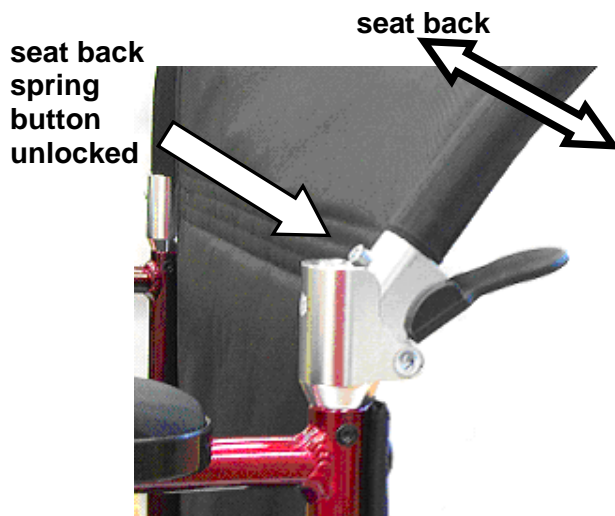

To return the seat back to the upright position:

1. Push the seat back up until the seat back release assembly spring buttons click fully into the folding mechanism on both sides. You should see the spring buttons fully engaged from the front of the seat back canes.
2. Ensure the frame / handles are locked securely into place before using the chair for transport.

GENERAL USE INSTRUCTIONS

WHEEL LOCKS



WHEEL LOCK WARNINGS

- Check the wheel locks to ensure proper function before using the chair. Wheel locks should embed into the wheel at least 1/8 inch when engaged.
- Engage the wheel locks on both wheels before entering the chair, leaving the chair, leaning forward in the chair or while being transported in an elevator or a wheelchair lift.
- Check to make sure that the legrests do not unlock the wheel locks when they are swung back.
- **DO NOT** use the wheel locks (or hand grip locks if present) to stop the wheelchair from moving. Wheel locks are not brakes. **DO NOT** use the wheel locks to slow your descent down an incline.

For models: MDS808150, MDS808200

To Engage the Wheel Locks

- Push down on the wheel lock handle to LOCK the chair.
- Pull up on the wheel lock handle to UNLOCK the chair.

MDS808150
MDS808200

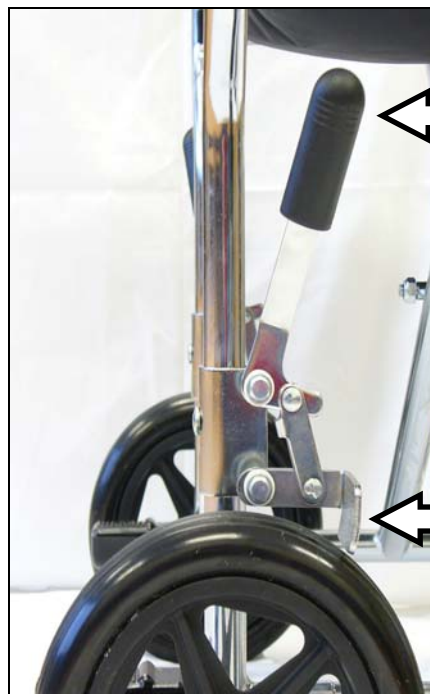

wheel
lock
handle

wheel
lock

GENERAL USE INSTRUCTIONS

WHEEL LOCKS

To Adjust the Wheel Locks for MDS808150, MDS808200

1. Loosen the bolt located on inside of Wheel Lock Assembly under seat.
2. Slide Wheel Lock Assembly to desired Height.
3. Tighten the bolt located on inside of Wheel Lock Assembly under seat

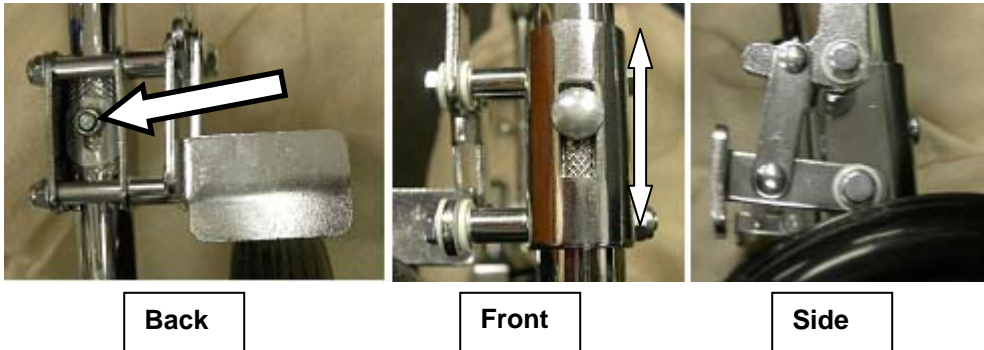

For models: MDS808210AR, MDS808210AB & MDS808210TC

To Engage the Wheel Locks

- Push down on the wheel lock handle to LOCK the chair.
- Pull up on the wheel lock handle to UNLOCK the chair.

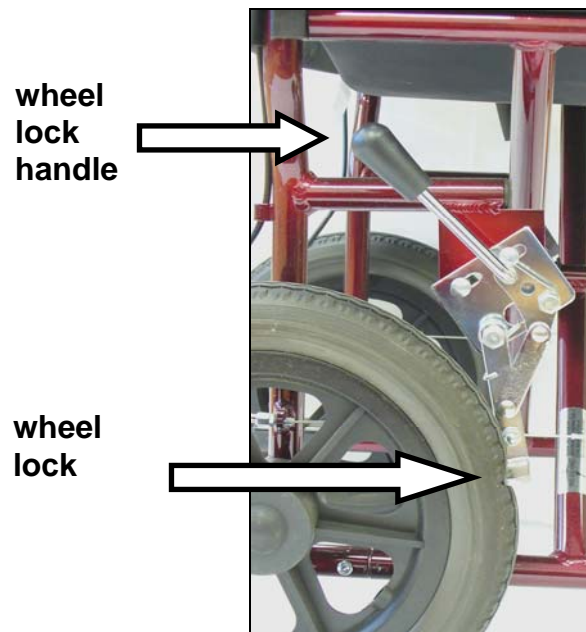

**MDS808210AR
MDS808210AB
MDS808210TC**

GENERAL USE INSTRUCTIONS

For models: MDS808200AR, MDS808200AB, MDS808200SLRR,
MDS808200SLBR, MDS808200SLRC & MDS808200SLBC

To Engage the Wheel Locks

- Pull up on the wheel lock handle to LOCK the chair.
- Push down on the wheel lock handle to UNLOCK the chair.

Wheel
Lock
Handle

MDS808200AR
MDS808200AB
MDS808200SLR
MDS808200SLRC



Wheel
Lock

To Adjust the Wheel Locks for MDS808200SLRR, BR, MDS808200SLRC, BC

1. Loosen both bolts located on inside of Wheel Lock Assembly under seat.
2. Slide Wheel Lock Assembly to desired Height.
3. Tighten both bolts located on inside of Wheel Lock Assembly under seat



GENERAL USE INSTRUCTIONS

For models: MDS808210AR, MDS808210AB, MDS808210TC

A. To Adjust the Wheel Lock Assembly to the wheel

1. Loosen both bolts located on inside of Wheel Lock Assembly under seat.
2. Slide Wheel Lock Assembly to desired Height.
3. Tighten both bolts located on inside of Wheel Lock Assembly under seat



B. To Adjust the Wheel Lock Assembly Cable to Handbrake

1. Loosen the cable retaining bolt
2. Pull cable to desired tightness
3. Tighten cable retaining bolt



GENERAL USE INSTRUCTIONS

For models: MDS808210AR, MDS808210AB, MDS808210TC

To use Locking Hand Grip Brakes



Handle grip wheel lock in open / unlocked position.

Squeeze brake to hold chair in stopped position.

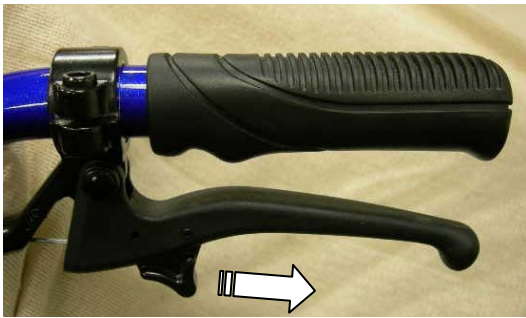

Handle grip wheel lock in closed / locked position.

To Lock, squeeze handle and with other hand push lock forward. Release handle while holding lock forward.

To Release, squeeze handle.

Installing / Removing the Swing-away Legrest / Footrest Riggings

To Install the Riggings:

1. Hold the legrest rigging to the side of the wheelchair.
2. Install the legrest assembly hinge plates onto the hinge pins of the wheelchair frame.
3. Push the legrest rigging to the front until it locks securely into place.

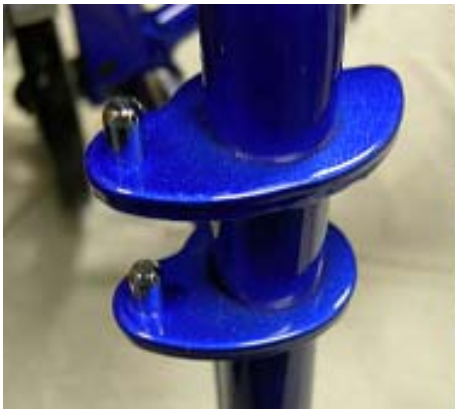

GENERAL USE INSTRUCTIONS

To Swing-away / Remove the Legrest assembly:

1. Fold the footplate up to the vertical position.
2. Release the legrest lock by pushing on the legrest lever.
3. Swing the legrest outward and to the side.
4. To remove the legrest, lift up on the assembly to remove the legrest off the hinge pins.



SAFETY INSPECTION & MAINTENANCE

It is highly recommended that the transport wheelchair be taken to a qualified dealer annually for a thorough inspection and maintenance / repair service.

GENERAL CARE

- Wipe off chrome / aluminum parts at least once per week using a clean, soft cloth.
- Clean all metal parts with auto wax or similar products.
- Dry the chair immediately if exposed to moisture.
- Do not use abrasive cleanser or materials that will scratch the finish of the chair.
- Clean the upholstery with a mild soap solution, rinse and wipe dry.
- Clean the hand grips with water only and dry thoroughly. Use of soap or ammonia-based cleaning solutions may loosen the grips.

MONTHLY CHECK LIST / TROUBLESHOOTING

General:

Inspect the entire wheelchair for broken parts, sharp edges and loose fasteners. Ensure that everything works and the chair rolls straight without drag and does not pull to one side. Replace or tighten parts as needed. Inspect for bent frame and crossbars.

Frame and Crossbraces:

Check that the frame and crossbraces are not bent or dented. Check the tubing for cracks and rust. If such issues are found, take the wheelchair to your local service dealer.

SAFETY INSPECTION & MAINTENANCE

Upholstery:

Inspect for any rips, tears or worn spots and replace as necessary. Inspect the upholstery screws and assure that all are present and tight. Torn or worn upholstery may not support the user's weight and could result in a fall with serious bodily injury.

Seat back:

Ensure the seat back folding mechanism is functioning properly and the seat back locks securely in the upright position.

Armrests:

Check for cracks, looseness, or sharp edges.

Hand grips:

Ensure the hand grips are tight and secure on the handles. They should not move or twist.

Footrests / Legrests:

Ensure the legrest assembly release works properly. Ensure the assembly automatically locks securely into place when attached and will not accidentally unlock.

Front Caster Forks:

Verify the forks swivel freely without binding. Check to ensure the casters roll freely by lifting the chair and spinning the caster. The caster should come to a gradual stop. If the nut is too loose, the caster will flutter or shimmy. If the nut is too tight, the chair will be difficult to steer. Check the bearings and clean the fork stem housing.

Front Casters and Rear Wheels:

Ensure the caster / wheel axle and nut are tight. The fork housing and the rear and front wheels are constructed with low maintenance, sealed bearings to keep dirt out and increase the durability of the chair. Bearings are also protected with an additional bearing spacer component. Check that the wheels are not warped, cracked or otherwise damaged and the spokes are not broken. Replace as needed. Assure that the wheels spin freely. Replacement and maintenance of wheel bearings should be completed by a qualified wheelchair technician only.

Front and Rear Tires:

Solid tires require minimal maintenance. They should occasionally be cleaned with a damp cloth. Replace the tires if they become cracked, excessively worn, or have flat spots.

MAINTENANCE

Installing / Removing Front Wheels



1. Remove wheel axle and nut.
2. Be sure to replace with the proper size wheel.
3. Install wheel, axle, and nut

Installing / Removing Rear Wheels

Warning:

After changing a rear wheel, check wheel locks for proper adjustment before use.



1. Remove hubcap if present.
2. Remove wheel axle and nut.
3. Be sure to replace with the proper size wheel.
4. Install wheel, axle, and nut.
5. Check wheel locks for proper adjustment after changing the wheel.

Wheel Locks

Check to ensure both locks engage correctly and embed in the tire at least 1/8 inch. If the lock is worn or damaged, it needs to be replaced. Make sure the locking assembly is securely attached to the frame and the wheel will not move when the lock is engaged. Make sure the wheel lock does not interfere with wheel rotation when the lock is not engaged. See wheel lock adjustment instructions in the General Use section.

MAINTENANCE

Hand grip wheel locks (select models):

Check to ensure the hand grips cause the wheel locks to engage correctly and embed in the tire at least 1/8 inch. If the lock is worn or damaged, it needs to be replaced. Make sure both the intermittent and full lock functions work by testing the hand grips in both the up and down positions. Ensure the chair will not move when the hand lock is engaged. Make sure the wheel lock does not interfere with wheel rotation when the lock is not engaged. See wheel lock adjustment instructions in the General Use section.

Cautions:

Use only Medline Industries, Inc. authorized accessories and parts.

DO NOT modify the wheelchair. Examples: drilling holes, grinding, welding parts, using non-authorized / non-approved parts. Such modifications may change the chair's structure and center of balance, which may increase the risk of serious injury to the user and void the warranty.

Medline Limited Warranty

Medline has great confidence in the quality of our wheelchairs. That is why Medline warrants for the original purchaser, that the frame of the wheelchair will be free from defects in materials and workmanship for the life of the chair.

Medline also warrants the parts and upholstery on the wheelchair to be free from defect in materials and workmanship for a period of one (1) year from date of purchase by the original purchaser.

If within the warranty period any such product shall be proven to be defective, such product shall be repaired or replaced, at Medline's option.

This warranty does not cover device failure due to owner misuse or negligence, or normal wear and tear.

All warranty claims must include the product in question unless otherwise authorized by Medline.

For more information about your wheelchair, warranty or to reorder parts call 1-800-MEDLINE.

SAFETY INSPECTION CHECKLIST

ITEM	INITIALLY	INSPECT / ADJUST WEEKLY	INSPECT / ADJUST MONTHLY	INSPECT / ADJUST PERIODICALLY
GENERAL Chair rolls straight. (no excessive pull to one side)	X			X
CLEANING Wipe chrome parts with clean, soft cloth. Auto wax / similar product on metal parts. Clean upholstery with mild soap solution. Use only water on hand grips. Dry chair immediately when wet. Do not use abrasive cleansers or cloths.	X X X	X		X X X
FRAME & CROSSBRACES Inspect for loose or missing hardware. Inspect for bent frame or crossbraces.	X X			X X
SEAT AND BACK UPHOLSTERY Inspect for rips or sagging. Inspect for loose or broken hardware.	X X		X	X
FRONT CASTERS AND REAR WHEELS Inspect wheel / fork assembly for proper tension by lifting the chair and spinning the caster. It should come to a gradual stop. Loosen locknut if wheel wobbles / tighten locknut if wheel binds to a stop. Ensure wheel bearings are clean and free of moisture.	X X X	X X		X
REAR WHEELS No excessive side movement or binding when chair is lifted and wheels are spun.	X		X	
FRONT AND REAR TIRES Inspect for flat spots and wear.	X	X		
HAND GRIP WHEEL LOCKS Test in both complete and intermittent lock positions. Ensure the chair does not move when the locks are engaged.	X X X		X X X	
FOLD DOWN SEAT BACK MECHANISM Ensure the seat back folding mechanism works smoothly and locks securely into place when seat back is upright.	X X X		X X X	
WHEEL LOCKS Do not interfere with tires when rolling. Pivot points free of wear and looseness. Wheel locks easy to engage.	X X X		X X X	
Take the transport chair to a qualified dealer annually for a thorough inspection and maintenance / repair services.				

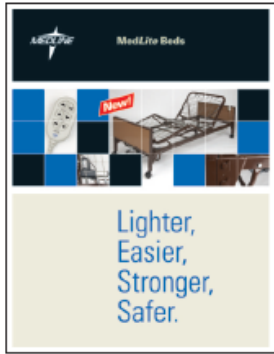
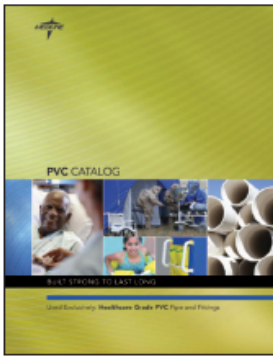

GET ALL THE DETAILS

Contact your Medline sales representative for one of our other great catalogs and to find out how we can help you with your wheelchair needs.

Use only GENUINE MEDLINE PARTS

Keep your Medline wheelchair running in top shape by using only Genuine Medline Parts. Ask your Medline sales representative for a parts catalog containing easy-to-read exploded view diagrams for all of our chairs.

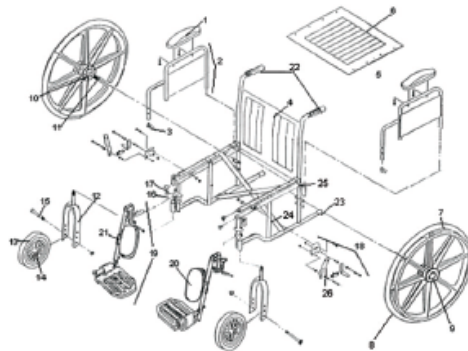

Medline Industries, Inc.

One Medline Place
Mundelein, IL 60060

Medline United States
1-800-MEDLINE (663-5463)

Medline Canada
1-800-396-6996

Medline Mexico
01-800-831-0898

www.medline.com Info@medline.com www.medline.ca Canada@medline.com www.medlinemexico.com mexico@medline.com

Some products may not be available for sale in Mexico or Canada. Please contact your Account Representative for additional information.

We reserve the right to correct any errors that may occur within this Owners Guide. ©2009

Medline Industries, Inc. Medline is a registered trademark of Medline Industries, Inc.